

## 2 Bedroom

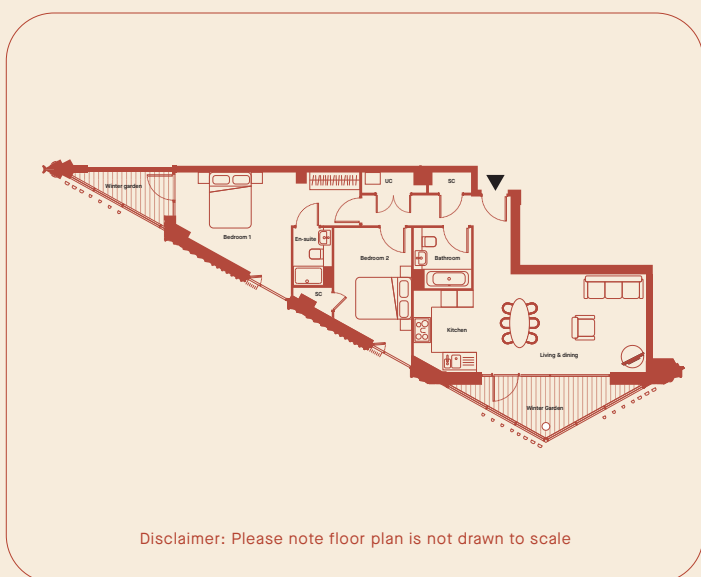

|                  |                                 |
|------------------|---------------------------------|
| Size             | 902 sq ft average               |
| Floors           | 2 – 12                          |
| Deposit          | one month's rent                |
| Rent             | from £3,765 pcm                 |
| Council Tax band | B, E and F (Wandsworth Borough) |
| EPC Rating       | B                               |
| Type of tenancy  | 12 Months – 3 years+            |

### FEATURES

- Residents' gym
- A winter garden in every flat
- Furnished or unfurnished flats available
- 24-hour concierge
- Communal terrace
- Underfloor heating that can be controlled in individual rooms
- Lift access

### GOOD TO KNOW

- Tenants are responsible for the payment of utilities, Wi-fi and council tax
- All tenancy applications subject to referencing